

Application

CJX2-F series AC contactor (hereinafter referred to as contactor), mainly used for AC 50Hz or 60Hz, rated insulation voltage 1000V, in the AC-3 use category rated operating voltage is 380V rated current to 800A in the circuit, for the far The distance is used for switching on and off circuits, and an electromagnetic starter can be formed with an appropriate thermal overload relay to protect the circuit from which an operational overload may occur. The contactor is suitable for frequently starting and controlling the AC motor. This product complies with GB14048.4 and IEC60947-4-1 standards.



CJX2- F115



CJX2- F265



CJX2- F630



CJX2- F1250

Model and Referring

CJ X 2 - F □ □

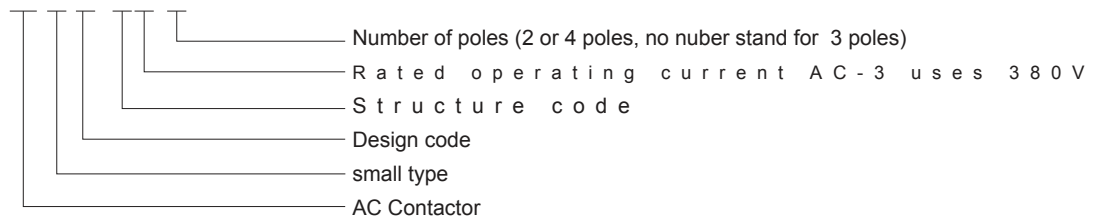

Normal Working and Installation Conditions

- The ambient air temperature is: -5 °C ~ +40 °C, the average value within 24 hours does not exceed +35 °C;
- Altitude: no more than 2000m;
- Atmospheric conditions: the relative humidity of the atmosphere does not exceed 50% at +40 °C; higher relative humidity is allowed at lower temperatures, the monthly minimum temperature of the wettest month does not exceed 25 °C, and the monthly average of the month is the largest The relative humidity does not exceed 90%, and measures must be taken for condensation on the product due to temperature changes;
- Pollution level: 3;
- Installation category: Class III;
- Installation conditions: the inclination of the mounting surface and the vertical plane is not more than ±5°;
- Shock vibration: The product should be installed and used in places where there is no significant shaking, shock and vibration.

Structure Feature

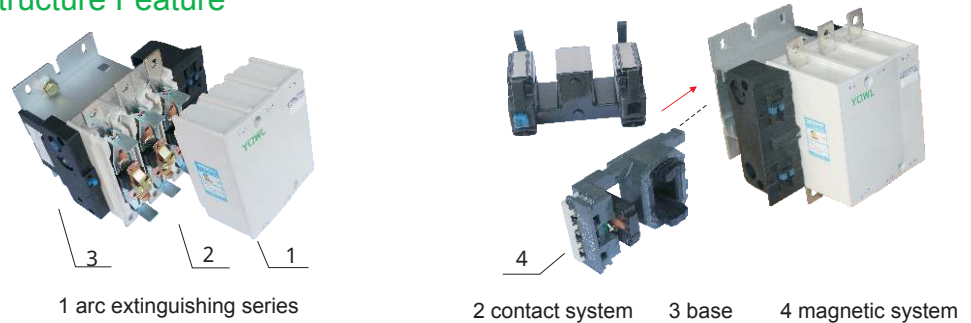

Figure 1 Schematic diagram of the overall structure of the CJX2-F115~F265 contactor

- The contact system of the contactor is a direct-acting, double-breakpoint arrangement. The lower base is made of aluminum alloy profile, the coil is a plastic package structure, and the coil and the yoke are integrated, which can be directly taken out or loaded from the contactor. , maintenance is extremely convenient; (see Figure 1)
- The contactor can be equipped with two auxiliary contact sets and more than 8 pairs of contacts;
- The arcing distance of the contactor is small. For example, the arcing distance of CJX2-F115~F330 is only 10mm (200~500V), which is only about one sixth of other contactors of the same capacity. It can be used as a complete set of equipment to reduce the occupied space, and is an excellent matching component in electronic control equipment;
- Auxiliary contact sets, air delay heads and other accessories can be installed by building block installation;
- Contact can be installed with horizontal or vertical mechanical interlock;
- Can be made into two, three and four pole contactors.

Main Parameters and Technical Performance

| Para Item | Spec Conventional heating current (A) | Rated working current (A) | | | High power (kW) of a controllable three-phase squirrel cage motor | | | Operating frequency times/h (AC-3) | AC-3 Electrical life (million times) | Mechanical life (million times) | Matching fuse type (SCPD) 型号 | each Weight (kg) | | |
|--------------|--|---------------------------|------|-------|---|------|-------|------------------------------------|--------------------------------------|---------------------------------|---------------------------------|------------------|------|------|
| | | AC-3 | | | AC-3 | | | | | | | 2P | 3P | 4P |
| | | 380V | 660V | 1000V | 380V | 660V | 1000V | | | | | | | |
| CJX2-F115 | 200 | 115 | 86 | 46 | 55 | 80 | 65 | 600 | 60 | 300 | RT16-1 | - | 3.6 | 4.3 |
| CJX2-F150 | 200 | 150 | 107 | 50 | 75 | 100 | 65 | 600 | 60 | 300 | RT16-1 | - | 3.7 | 4.5 |
| CJX2-F185 | 275 | 185 | 118 | 71 | 90 | 110 | 100 | 600 | 50 | 300 | RT16-2 | - | 4.6 | 5.4 |
| CJX2-F225 | 275 | 225 | 135 | 90 | 110 | 129 | 100 | 600 | 50 | 300 | RT16-2 | - | 4.7 | 5.7 |
| CJX2-F265 | 315 | 265 | 170 | 112 | 132 | 160 | 147 | 600 | 50 | 300 | RT16-2 | - | 7.1 | 8.5 |
| CJX2-F330 | 380 | 330 | 225 | 155 | 160 | 220 | 160 | 600 | 50 | 300 | RT16-3 | - | 8.5 | 10 |
| CJX2-F400 | 450 | 400 | 235 | 200 | 200 | 280 | 185 | 300 | 30 | 100 | RT16-3 | 7.3 | 8.5 | 10 |
| CJX2-F500 | 580 | 500 | 290 | 232 | 250 | 330 | 315 | 300 | 30 | 100 | RT16-4 | 9.1 | 10.8 | 12.9 |
| CJX2-F630 | 800 | 630 | 360 | 331 | 335 | 450 | 425 | 300 | 20 | 100 | RT16-4 | 14.1 | 17.4 | 20.5 |
| CJX2-F780 | 830 | 780 | 440 | 400 | 400 | 470 | 450 | 300 | 20 | 100 | RT16-4 | 23.5 | 40 | - |
| CJX2-F800 | 860 | 800 | 450 | 415 | 400 | 470 | 450 | 300 | 20 | 100 | RT16-4 | - | 19 | - |
| CJX2-F1250 | 1260 | - | - | - | - | - | - | 300 | 20 | 100 | RT16-4 | - | 18.2 | - |

Action characteristics

The pull-in voltage is 85%~110%Us, and the release voltage is 20%~75%Us. Coil main specification code (see Table 2)

Table 2

| Coil code Contactor Item | Control voltage (V) | 110 | 127 | 220 | 380 | Average power consumption (20 °C) | | Each weight (kg) | picture |
|-----------------------------|---------------------|-------|-------|-------|------|-----------------------------------|-----------|---|---------|
| | | | | | | pull-in(VA) | hold(VA) | | |
| CJX2-F115、F150 | Ff110 | Ff127 | Ff220 | Ff380 | 550 | 45 | 0.44 |  | |
| CJX2-F185、F225 | FG110 | FG127 | FG220 | FG380 | 800 | 55 | 0.5 | | |
| CJX2-F265 | FH110 | FH127 | FH220 | FH380 | 1200 | 13 | 0.73 | | |
| CJX2-F330 | FH110 | FH127 | FH220 | FJ380 | 1200 | 13 | 0.84 | | |
| CJX2-F400 | FJ110 | FJ127 | FJ220 | FJ380 | 1200 | 20 | 0.96 | | |
| CJX2-F500 | FK110 | FK127 | FK220 | FK380 | 1250 | 24 | 1.1 | | |
| CJX2-F630 | FL110 | FL127 | FL220 | FL380 | 1650 | 22 | 1.3 | | |
| CJX2-F780 | FX110 | FX127 | FX220 | FX380 | 2100 | 50 | 2.6 | | |
| CJX2-F800 | Fl110 | Fl127 | Fl220 | Fl380 | 1650 | 22 | 1.5 | | |
| CJX2-F1250 | FL110 | FL127 | FL220 | FL380 | 1650 | 22 | 1.3 | | |

Connecting Wire Capacity

Table 3

| Parameter | Item | CJX2-F115 | CJX2-F150 | CJX2-F185 | CJX2-F225 | CJX2-F265 | CJX2-F330 | CJX2-F400 | CJX2-F500 | CJX2-F630 | CJX2-F780 | CJX2-F800 | CJX2-F1250 |
|-----------------|---------------------------------------|-----------|-----------|-----------|-----------|-----------|-----------|-----------|-----------|-----------|-----------|-----------|------------|
| Connecting wire | number of wire | 1 | 1 | 1 | 1 | 1 | 1 | 2 | 2 | 2 | 2 | 2 | 2 |
| | Wire cross section(mm ²) | 95 | 120 | 150 | 185 | 240 | 240 | 150 | 240 | 240 | 240 | 240 | 240 |
| | number of wire | 2 | 2 | 2 | 2 | 2 | 2 | 2 | 2 | 2 | 2 | 2 | 2 |
| | Copper bar(mm) | 20 × 3 | 25 × 3 | 25 × 3 | 32 × 4 | 32 × 4 | 30 × 5 | 30 × 5 | 40 × 5 | 60 × 5 | 60 × 5 | 60 × 5 | 60 × 5 |
| | Connection bolt | M6 | M8 | M8 | M10 | M10 | M10 | M10 | M10 | M12 | M12 | M12 | 3 × M2 |

Outshell and Mounting Dimension

Table 4 (unit : mm)

| Item | CJX2- | | EJX2- | | EJX2- | | EJX2- | | EJX2- | | EJX2- | | EJX2-F400 | | | CJX2-F500 | | | CJX2-F630 | | | CJX2-F800 | CJX2-F1250 |
|----------|---------|-----|---------|-----|---------|-------|---------|-------|---------|-----|---------|-----|-----------|-----|-----|-----------|-----|-----|-----------|-----|-----|-----------|------------|
| | 3P | 4P | 3P | 4P | 3P | 4P | 3P | 4P | 3P | 4P | 3P | 4P | 2P | 3P | 4P | 2P | 3P | 4P | 2P | 3P | 4P | 3P | 3P |
| A max | 167 | 204 | 167 | 204 | 170 | 211 | 170 | 211 | 202 | 247 | 218 | 261 | 215 | 215 | 261 | 235 | 235 | 288 | 310 | 310 | 389 | 310 | 310 |
| B max | 163 | 163 | 171 | 171 | 175 | 175 | 175 | 175 | 203 | 203 | 210 | 210 | 210 | 210 | 210 | 240 | 240 | 240 | 304 | 304 | 304 | 304 | 304 |
| C max | 172 | 172 | 172 | 172 | 183 | 183 | 183 | 183 | 215 | 215 | 223 | 223 | 223 | 223 | 223 | 235 | 235 | 235 | 257 | 257 | 257 | 257 | 257 |
| P | 37 | 37 | 40 | 40 | 40 | 40 | 48 | 48 | 48 | 48 | 48 | 48 | 48 | 48 | 48 | 55 | 55 | 55 | 80 | 80 | 80 | 80 | 80 |
| S | 20 | 20 | 20 | 20 | 20 | 20 | 25 | 25 | 25 | 25 | 25 | 25 | 25 | 25 | 25 | 30 | 30 | 30 | 40 | 40 | 40 | 40 | 40 |
| Φ | M6 | M6 | M8 | M8 | M8 | M8 | M10 | M10 | M10 | M10 | M10 | M10 | M10 | M10 | M10 | M10 | M10 | M10 | M12 | M12 | M12 | M12 | M12 |
| f | 131 | 131 | 131 | 131 | 131 | 131 | 131 | 131 | 147 | 147 | 147 | 147 | 147 | 147 | 147 | 150 | 150 | 150 | 181 | 181 | 181 | 181 | 181 |
| M | 147 | 147 | 150 | 150 | 154 | 154 | 172 | 172 | 178 | 178 | 181 | 181 | 181 | 181 | 181 | 208 | 208 | 208 | 264 | 264 | 264 | 264 | 264 |
| H | 124 | 124 | 124 | 124 | 127 | 127 | 127 | 127 | 147 | 147 | 158 | 158 | 158 | 158 | 158 | 172 | 172 | 172 | 202 | 202 | 202 | 202 | 202 |
| L | 107 | 107 | 104 | 107 | 113.5 | 113.5 | 113.5 | 113.5 | 141 | 141 | 145 | 145 | 145 | 145 | 145 | 146 | 146 | 146 | 155 | 155 | 155 | 155 | 155 |
| X1 200 V | 10 | 10 | 10 | 10 | 10 | 10 | 10 | 10 | 10 | 10 | 10 | 10 | 15 | 15 | 15 | 15 | 15 | 15 | 20 | 20 | 20 | 20 | 20 |
| X1 660 V | 15 | 15 | 15 | 15 | 15 | 15 | 15 | 15 | 15 | 15 | 15 | 15 | 20 | 20 | 20 | 20 | 20 | 20 | 30 | 30 | 30 | 30 | 30 |
| Ga | 80 | 80 | 80 | 80 | 80 | 80 | 80 | 80 | 96 | 96 | 96 | 96 | 80 | 80 | 80 | 80 | 80 | 80 | 180 | 180 | 180 | 180 | 180 |
| Ha | 106/119 | | 106/119 | | 106/119 | | 106/119 | | 106/119 | | 106/119 | | 170/180 | | | 170/180 | | | 180/190 | | | 180/190 | 180/190 |

Note: a.f: The small distance required to take out each coil.

.x b1: Arcing distance determined based on operating voltage and breaking capacity.



图1 JX2- F115 F330



图 2JX2- F400 F500

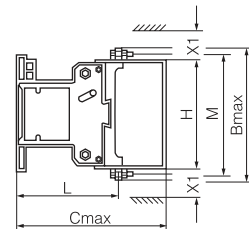
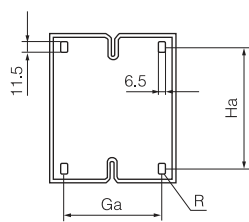
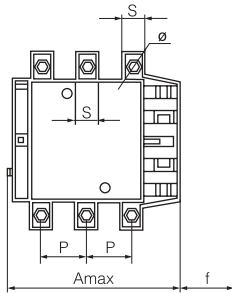

图3 JX2- F630 □F1250

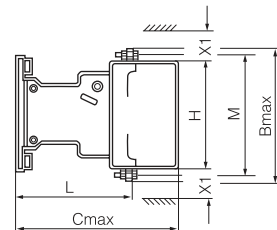
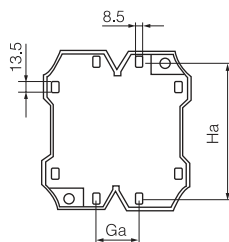
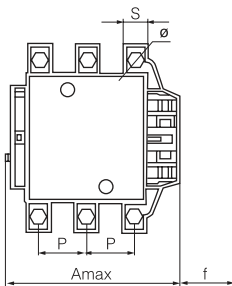

图4 JX2- F780

Ordering Instruction

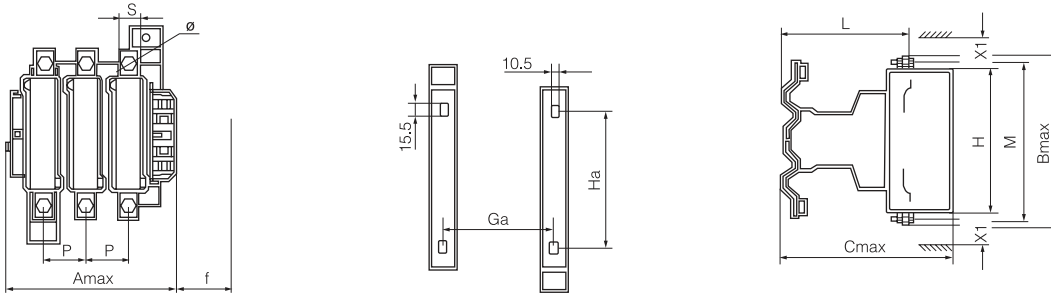
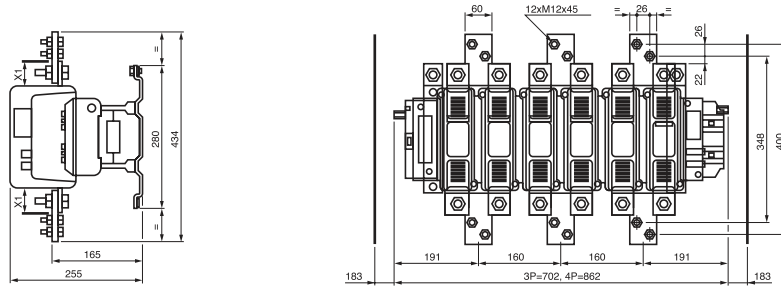
When ordering, it must be pointed out: product model name, coil working voltage and frequency, quantity

Example: AC contactor CJX2-F265 AC 220V 50Hz 60 sets.